

# EVERYBODY

## *Between Land and Sky*

Azadeh Gholizadeh, Luis  
Romero, and Soo Shin

Curated by Nazafarin Lotfi

Everybody is pleased to present *Between Land and Sky*, a group show featuring works by Azadeh Gholizadeh, Luis Romero, and Soo Shin.

Between imagined places and physical locations, between ordinary and non-ordinary realities, space turns inside out. Figure and background intertwine. Marks blend with the surface to create systems and obscure languages. Negative space takes charge. Fragments replace the whole. Chance is the compass on these maps, and longing for the ground is the scale.

How do bodies live in such conditions, where space expands and contracts? How does one know in these uncertain fields? Upside down, inside out, this or that: none defines this uneasy relationship with the ground. In these lands, the very notion of landscape is questioned. The horizon is removed, and time moves in a cyclical manner.

Space does not flow forward, it moves up and down, between land and sky.

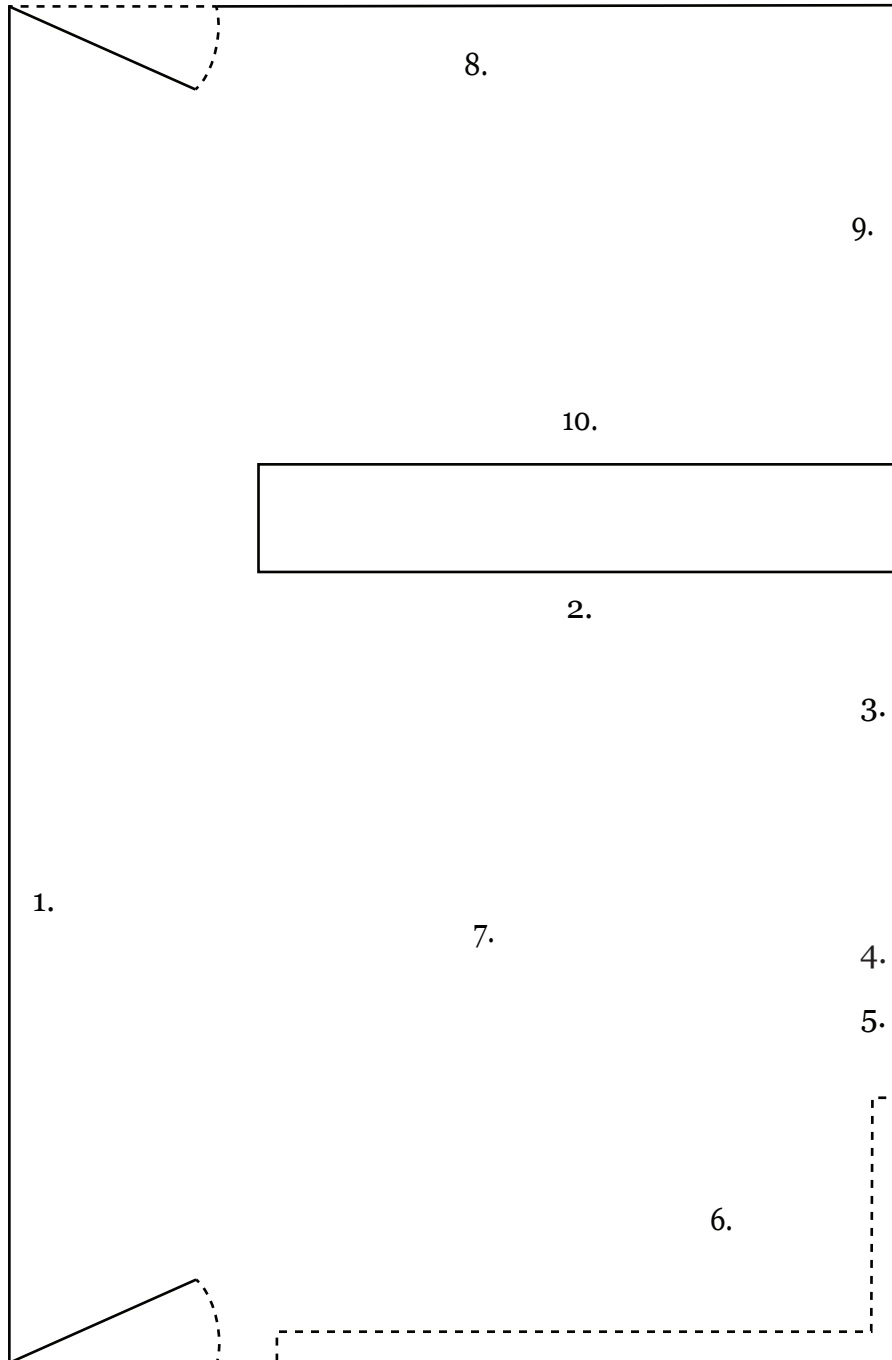

1. Luis Romero, *Mutant Map of the United States/ Shamanistic Drawing*, 2019, acrylic and ink on paper and cardboard, found materials

2. Luis Romero, *My Own Private Summer Something*, 2019, acrylic on paper

3. Luis Romero, *Untitled*, 2019, acrylic on paper

4. Azadeh Gholizadeh, *Labyrinth*, 2017, embroidery on archival inkjet print on rice paper

5. Azadeh Gholizadeh, *Knot*, 2017, embroidery on archival inkjet print on rice paper

6. Soo Shin, *Gesture: Reflection and Weight*, 2019, resin, glaze on stoneware, wood, steel

7. Soo Shin, *To Contain Sights*, 2018, wood, glaze on stoneware, house paint

8. Soo Shin, *Untitled*, 2017, wood, plaster, concrete, steel

9. Luis Romero, *Tower with Cat Ears*, 2018, acrylic on paper

10. Azadeh Gholizadeh, *Untitled, part of "Oh, Swallow Where do you Live in Winter?"*, 2018-19, inkjet on fabric, silk, cotton and mohair